



P.O. Box 1719  
 Corona, CA 92878  
 Support: 951-493-7100  
 www.aFeFilters.com

# Intake Kit Installation Instructions: '07 Chevrolet Tahoe/ Suburban/ GMC Yukon/ Yukon XL V8-5.3L

<b>Kit Part #</b>	51/54-11071 <b>Stage 1</b>	<b>Tools Required:</b>	<b>Part List: ( stage 1 )</b>	<b>( stage 2 )</b>
	51/54-11072 <b>Stage 2</b>	5/16" nut driver or slotted screwdriver	1 Air filter (replacement # 24-90015) or	1 Intake tube
<b>Make:</b>	Chevrolet	10mm socket or wrench	<b>Pro Dry S™</b> 21-90015	1 3/8" Hose @14"L
<b>Model</b>	<b>Year</b> <b>Engine</b>	4mm or 5/32 hex head wrench	1 Intake housing	1 Nipple, brass 1/4"
Tahoe	'07 V8-5.3L	Ratchet and extension	1 Cover, aluminum	2 Coupler, reducer 05-00020
Suburban	'07 V8-5.3L		1 Coupler, reducer 05-00834	2 Clamp #072
<b>Make:</b>	GMC		1 Clamp #072	2 Clamp #064
<b>Model</b>	<b>Year</b> <b>Engine</b>		1 Clamp #064	
Yukon	'07 V8-5.3L		8 Screw, button head M6x1x10	
Yukon XL	'07 V8-5.3L		1 Adapter, injection molded	



**Step 1**  
 Complete intake kit. Please verify all components are present prior to beginning installation.

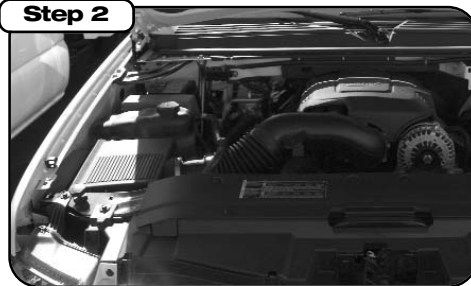

**Step 2**  
 Complete stock intake system.

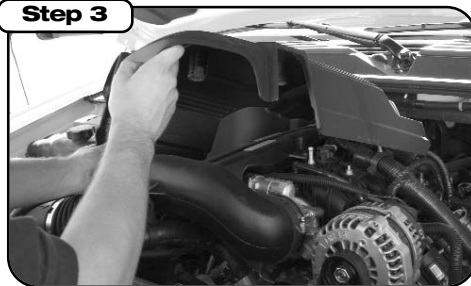

**Step 3**  
 Remove engine cover, lift up and pull out.



**Step 4**  
 Loosen the clamp attaching the MAF sensor to the intake housing.



**Step 5**  
 Remove the MAF sensor from the housing.



**Step 6**  
 Lift up and out to remove the stock air box.

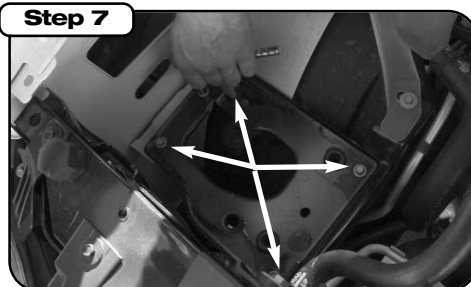

**Step 7**  
 Remove the 4 bolts that fasten the air box mounting plate. Remove the plate and save the bolts for later use.

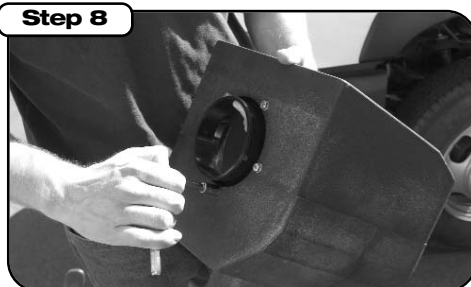

**Step 8**  
 Using (5) M6 button head screws fasten the air filter adapter to the aFe intake housing.



**Step 9**  
 With the filter adapter and reducer coupler installed, lower the aFe intake housing into the engine compartment.



**Step 10**  
 Using the 4 bolts from the stock mounting plate fasten the aFe intake housing on the chassis.



**Step 11**  
 Using the reducer coupler, insert and clamp the MAF sensor onto the aFe housing.



**Step 12**  
 Insert and fasten the aFe air filter.



**Step 13**  
 Install the housing cover and fasten using three button head screws.

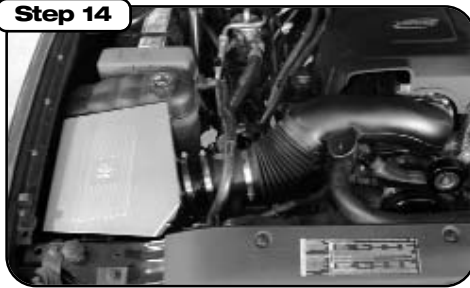

**Step 14**  
 Your installation is now complete. Make sure to tighten all clamps and check all electrical connections. Re-tighten clamps after a few hours of operation.

**Note:** Filter Cleaning and Re-oiling: When cleaning your aFe filter, be sure to use only aFe's "Restore Kit" (aFe P/N: 90-50001 blue oil aerosol, or aFe P/N: 90-50501 blue squeeze bottle oil or aFe P/N: 90-50000 gold oil aerosol, or aFe P/N: 90-50500 gold squeeze oil). Filter Replacement: Magnum FLOW PN: #24-90015 (black w/ blue media). **Pro Dry S™** P/N: 21-90015 (black w/ white media) **Pro Dry S™** cleaning: see cleaning instruction sheet 06-00074